

MONOCLONIUS

UCX24-E004/E004A

Rechargeable LiPo Battery

OPERATING INSTRUCTIONS

可充电电池操作指南

V1.0

Read and follow all precautions before use. Improper use of batteries may lead to danger.

使用前阅读并遵守所有注意事项。不当使用电池可能会导致危险。

BATTERY SAFETY 电池注意事项

- It is normal for the battery to heat up after operation.
- Please be careful when handling the battery. If the wire is worn, it is easy to short circuit and cause fire.
- Pay attention to the polarity of the battery when installing or replacing the battery.
- Keep away from damp, corrosive environment and heat source.
- DO NOT short circuit, decompose or put the battery into fire.
- Please use the attached special charger to charge the battery.
- Remove the battery from the model before charging.
- Disconnect the power and unplug the plug after using.
- DO NOT charge the battery when it is bulging or expanding.
- Please charge the battery under adult supervision.
- DO NOT short circuit any terminals.

- 使用后，请断开电源并拔下插头。
- 请远离潮湿、腐蚀性环境和热源。
- 不当使用电池可能会导致危险。
- 电池鼓起或膨胀时不要充电。
- 非充电电池不能充电；
- 充电电池必须在成人监护下充电；
- 充电电池在充电前应从产品中取出；
- 电池使用过程发热属正常现象。电线磨损容易短路并引发火灾，请小心处理。
- 电池取出和装入应按产品的极性和电压标志正确操作，电池不应短路；
- 只有和推荐电池相同或者等效的电池方可使用；
- 用尽的电池应从产品中取出，若长期不使用，请将产品中电池取出；
- 电源端子不得短路；
- 不能连接到多于推荐数量的电源上。
- 充电电池组只能使用生产者提供的USB线进行充电，USB线不是模型。



**▲ WARNING
FIRE HAZARD!
注意防火**

BATTERY DATA 电池参数

Model (型号) : UCX24-E004/E004A	Battery Type (电池类型) : LiPo
Capacity (容量) : 350 mAh	Voltage (电压) : 7.4 V
Size (规格) : 51×30×7.5mm	Net Weight (重量) : 22.7 g
Charging time (充电时间) : about 60s (约60分)	Input (输入功率) : 5V, 2A
Output/Input Port (输出/输入端口) : XH2.54-3P	

BATTERY CHARGING 电池充电

The battery contains less power when leaving the factory, so it must be fully charged before use. Do not place the battery in the model while charging. The battery must be cooled before being recharged. Connect the included USB charging cable to the battery charging port, and then connect to other USB output ports (output: 5V, 2A). The USB charger indicator light will red when charging and the light turns green when fully charged.

电池出厂时含有较少电量，须充电饱和后再使用。电池充电时禁止安放于模型中。电池必须冷却后再充电。将随附USB充电线与电池充电端口连接，再连接其它USB输出端口(输出:5V, 2A)。充电时充电线指示灯绿色闪烁；充电完成绿色长亮。

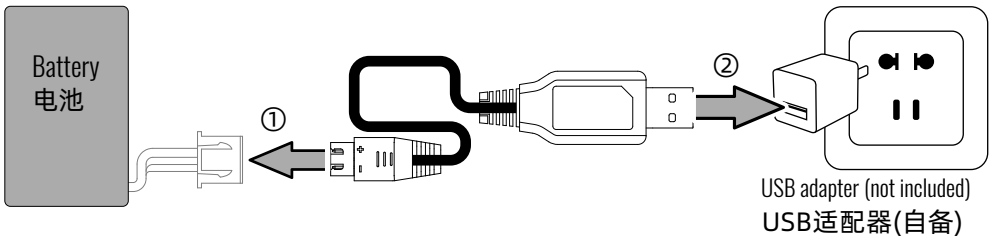

WARNING: MUST BE SUPERVISED WHILE CHARGING.

Please use the included USB charging cable and make sure it is properly connected.

警告：充电时必须有人照看。

请使用设备随附的充电器并确保连接正确。

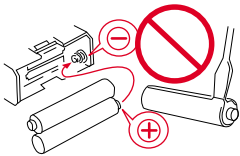

Please don't reverse contact or disassemble the battery, as this way will cause the battery to explode.

勿反接或分解电池，这会导致电池爆炸的危险。

Li-Po Battery Disposal & Recycling

Wasted Lithium-Polymer batteries must not be placed with household trash. Please contact local environmental or waste agency or the supplier of your model or your nearest Li-Po battery recycling center.

锂电池处理与回收

废旧锂聚合物电池不得与家庭垃圾放在一起。请联系当地环保或废物处理机构或您的产品供应商或离您最近的锂电池回收中心。

