

**UDI R/C**

**SKATER**  
BOAT

# OPERATING INSTRUCTIONS

V1.0

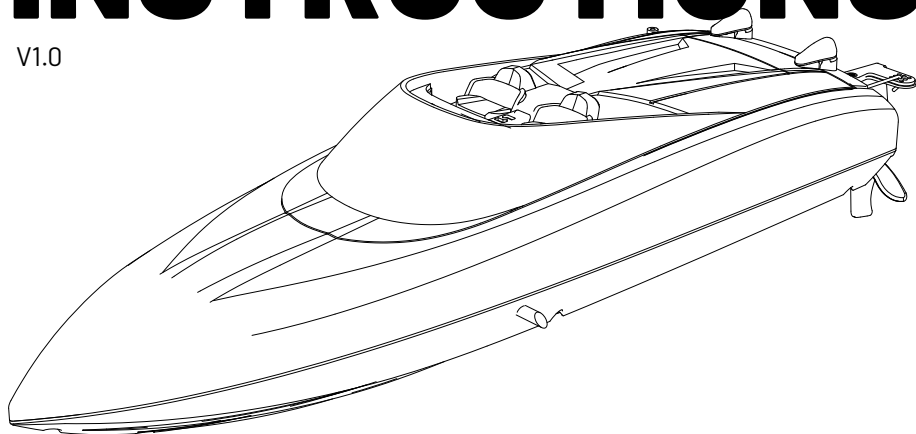

This product is suitable for  
users over 14 years old.  
Please read this instruction  
manual carefully before use.



**DANGER!**  
Only suitable for age 14+

# IMPORTANT NOTICE

## The package or instruction manual contains important information and must be retained.

Our company's products are improving all the time, design and specifications are subject to change without notice. All the information in this manual has been carefully checked to ensure accuracy, if any printing errors, our company reserve the final interpretation right.

# THANK YOU

- Thank you for choosing this product. If you have any problems or need help, please call us and we will try our best to help you.
- This is a radio control model product, not a toy! which needs regular maintenance to obtain the best performance. If you don't do regular maintenance, it can affect performance. We have all the necessary parts and accessories to ensure that your boat maintains its best performance.
- The warning or attention symbol will alert you to potentially dangerous steps. Please read and understand the instructions carefully before proceeding.



**WARNING**



**ATTENTION**

*Failure to follow these instructions may result in injury to yourself or others. You may also cause property damage or model damage.*

**For more safety precautions, please refer to the "Disclaimer and Safety Operation Guidelines".**

**Usage: Please follow the instructions to install and operate the model.**

**STAY AWAY FROM THE ROTATING PROPELLER**

# ! SAFETY PRECAUTIONS

- 1) Turn on the transmitter power first and then turn on the boat power before playing; Turn off the boat power first and then turn off the transmitter power when finish playing.
- 2) Make sure the connection is solid between battery and motor etc. The ongoing vibration may cause bad connection of power terminal.
- 3) Improper operation may cause impact to the boat and damage the hull or propeller.
- 4) It is forbidden to sail in the water where people are useful and sail away from salt water and sundry water.
- 5) The battery must be take out after playing to keep the cabin dry and clean.

# ! WARNING

Warning: The product should only be used by adults and children over 14 years.

Adult supervision is required for children under 14 years.

Hinweis: Dieses Produkt ist für die Erwachsene und die Kinder ab 14 Jahren.

Die Kinder unter 14 Jahren müssen von Erwachsenen beaufsichtigt werden.

Avertissement: Ce produit est destiné aux adultes et aux enfants de plus de 14 ans.

Les enfants de moins de 14 ans doivent être surveillés par des adultes.

Avvertimento: Questo prodotto è destinato all'uso per i adulti e bambini di età superiore ai 14 anni.

I bambini di età inferiore ai 14 anni devono essere sorvegliati da un adulto.

Advertencia: Este producto es para adultos y niños mayores de 14 años.

Los niños menores de 14 años deben ser supervisados por adultos.

警告: この製品は、大人と14歳以上の子供には使用対象です。

14歳未満の子供は大人の監視が必要です。

اماع 14 نس قوف لافطال او ني غلابلا لبق نم طوقف جت نمل امدختسا بجي ريذحت

اماع 14 نس نود لافطال بولطم رابكل فارشا

## FCC NOTE

This equipment has been tested and found to comply with the limits for a Class B digital device, pursuant to Part 15 of the FCC Rules. These limits are designed to provide reasonable protection against harmful interference in a residential installation. This equipment generates uses and can radiate radio frequency energy and, if not installed and used in accordance with the instructions, may cause harmful interference to radio communications. However, there is no guarantee that interference will not occur in a particular installation. If this equipment does cause harmful interference to radio or television reception, which can be determined by turning the equipment off and on, the user is encouraged to try to correct the interference by one or more of the following measures:

- *Reorient or relocate the receiving antenna.*
- *Increase the separation between the equipment and receiver.*
- *Connect the equipment into an outlet on a circuit different from that to which the receiver is connected.*

**WARNING: Changes or modifications not expressly approved by the party responsible for compliance could void the user's authority to operate the equipment.**

### FCC Notice

The equipment may generate or use radio frequency energy. Changes or modifications to this equipment may cause harmful interference unless the modifications are expressly approved in the instruction manual. Modifications not authorized by the manufacturer may void user's authority to operate this device.

This device complies with Part 15 of the FCC Rules. Operation is subject to the following two conditions: (1) This device may not cause harmful interference. (2) This device must accept any interference received, including interference that may cause undesired operation.

### FCC Radiation Exposure Statement

The device has been evaluated to meet general RF exposure requirement.  
The device can be used in portable exposure condition with out restriction.

# RECHARGEABLE BOAT-BATTERY

## **!** BATTERY SAFETY

**Read and follow all precautions before use. Improper use of batteries may lead to danger.**

- It is normal for the battery to heat up after operation.
- Please be careful when handling the battery. If the wire is worn, it is easy to short circuit and cause fire.
- Pay attention to the polarity of the battery when installing or replacing the battery.
- Keep away from damp, corrosive environment and heat source.
- DO NOT short circuit, decompose or put the battery into fire.
- Please use the attached special charger to charge the battery.
- Remove the battery from the model before charging.
- Disconnect the power and unplug the plug after using.
- DO NOT charge the battery when it is bulging or expanding.
- Please charge the battery under adult supervision.
- DO NOT short circuit any terminals.



**! WARNING  
FIRE HAZARD!**



### Li-Po Battery Disposal & Recycling

Wasted Lithium-Polymer batteries must not be placed with household trash. Please contact local environmental or waste agency or the supplier of your model or your nearest Li-Po battery recycling center.



## CHARGING

Battery power is insufficient in the original plant. It must be charged saturated before it can be used. Connect the charging case to the charging input port of the boat-battery and then connect the USB output ports. The green indicator light flashes when charging and the green indicator light will keep bright fully charged. During the charging, battery should not be placed in the hull when charging and must be cooled before charging.

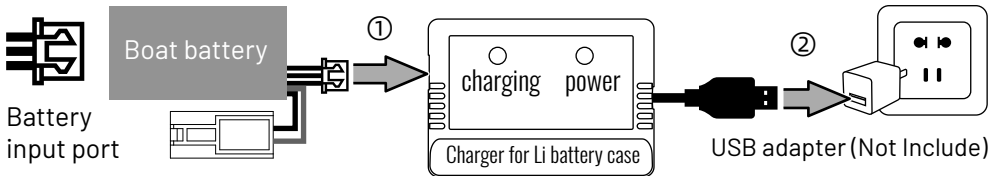

**WARNING: MUST BE SUPERVISED WHILE CHARGING.**

*Please use the included USB charging cable and make sure it is properly connected.*

# 2.4GHZ TRANSMITTER

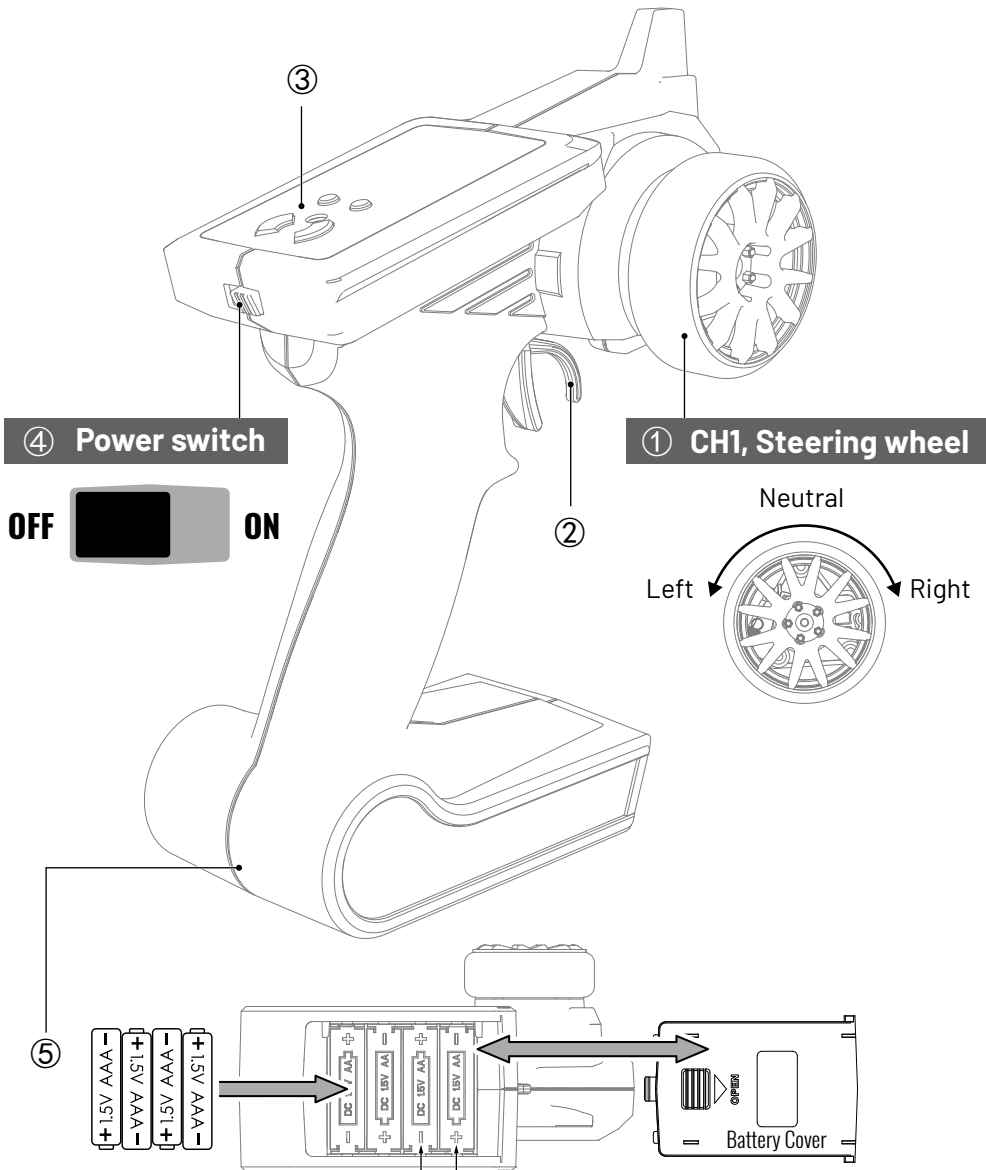

**! NOTE DIRECTION**

1.5V×4 AA Alkaline Batteries  
(not included)

Open the transmitter battery cover. Install batteries. Follow the direction of batteries designated in the inside of the battery box.

## ② CH2, Throttle trigger

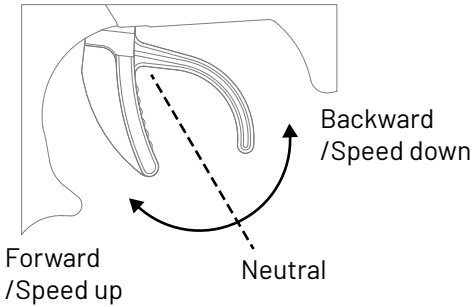

Note:

When using the transmitter in electric powered boat, the throttle trigger should always remain in the neutral position. Otherwise the boat may experience erratic operation of the throttle trigger functions.

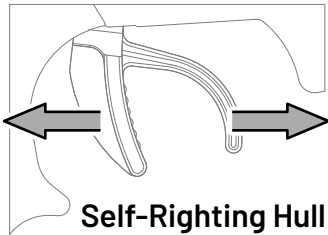

If the boat capsizes, Push forward and backward the throttle trigger of the transmitter and then pull back at once. The boat will then return to normal, the capsize reset function will turn off automatically when the boat in low battery.

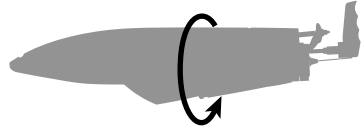

## ③ Regulatory interface



### Backward Trim

If the boat still moves forward when the throttle trigger is in the middle position, press backward trim until the boat stops going forward.

### Forward trim

If the boat still moves backwards when the throttle trigger is in the middle position, press forward trim until the boat stops going backwards.



### Left Rudder Trim

If the boat drifts to the right, press the left rudder trim on the transmitter and the boat will gradually correct the rudder alignment. It will start moving straight.

Power indicator

### Right Rudder Trim

If the boat drifts to the left, press the right rudder trim on the transmitter and the boat will gradually correct the rudder alignment. It will start moving straight.

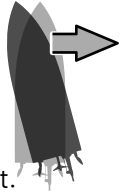

# BOAT SUMMARY

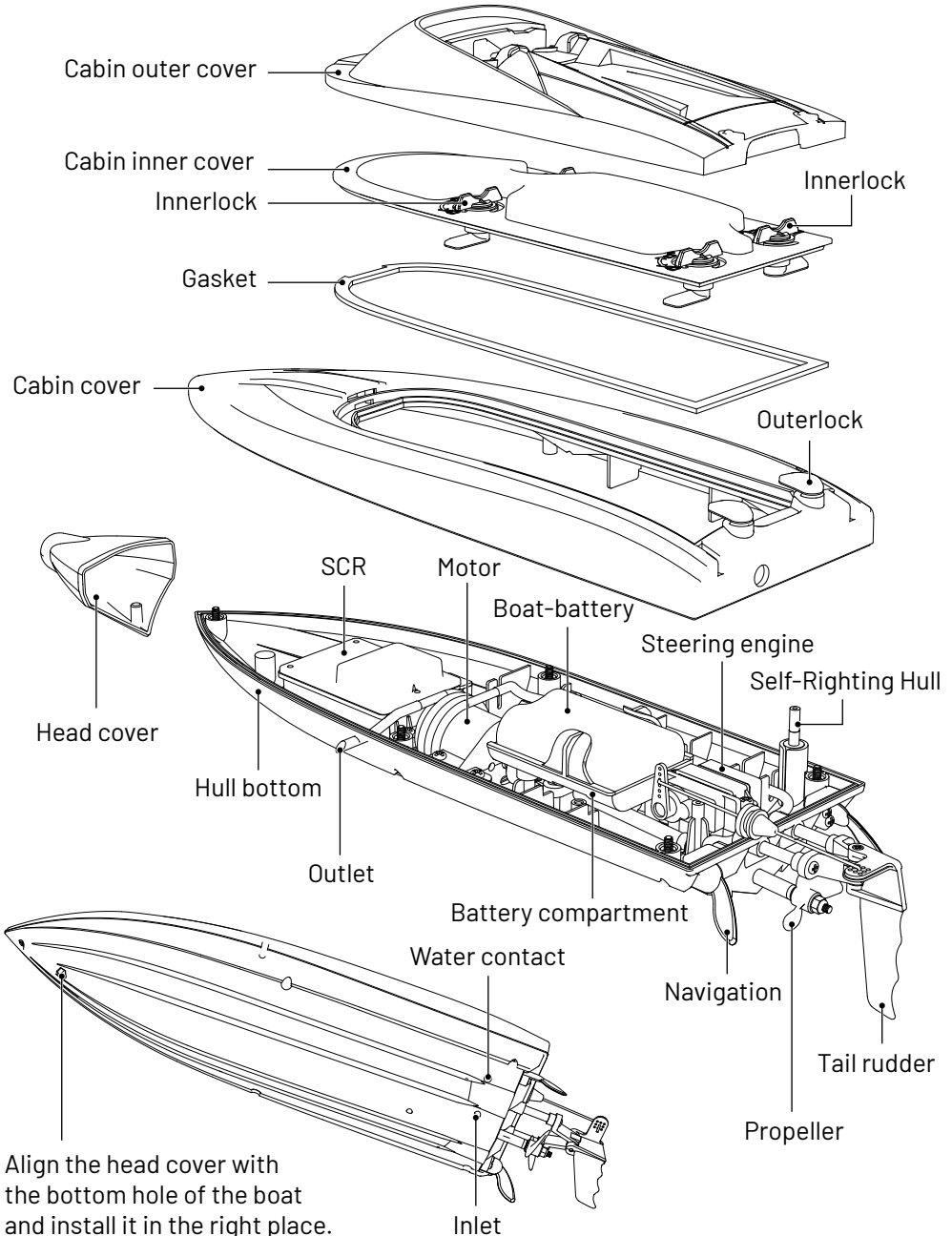

# Speed control & Receiver (SCR)

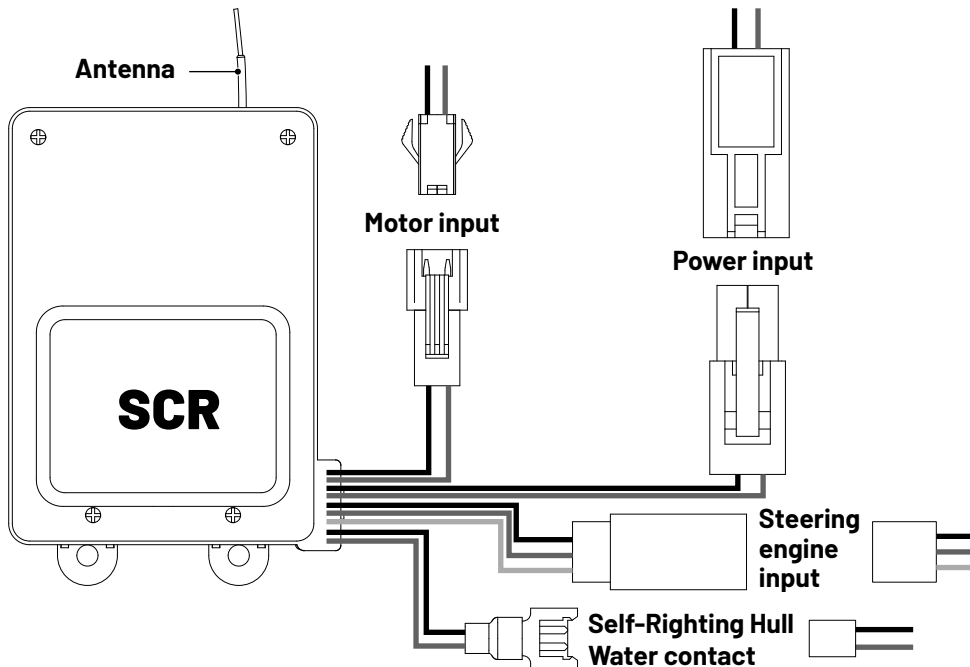

# Drive assembly

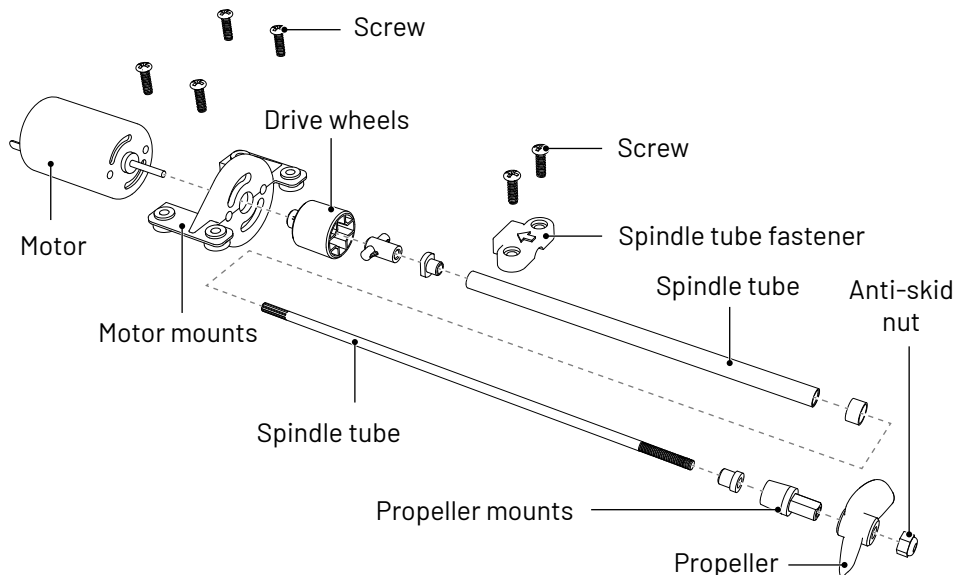



# Steering

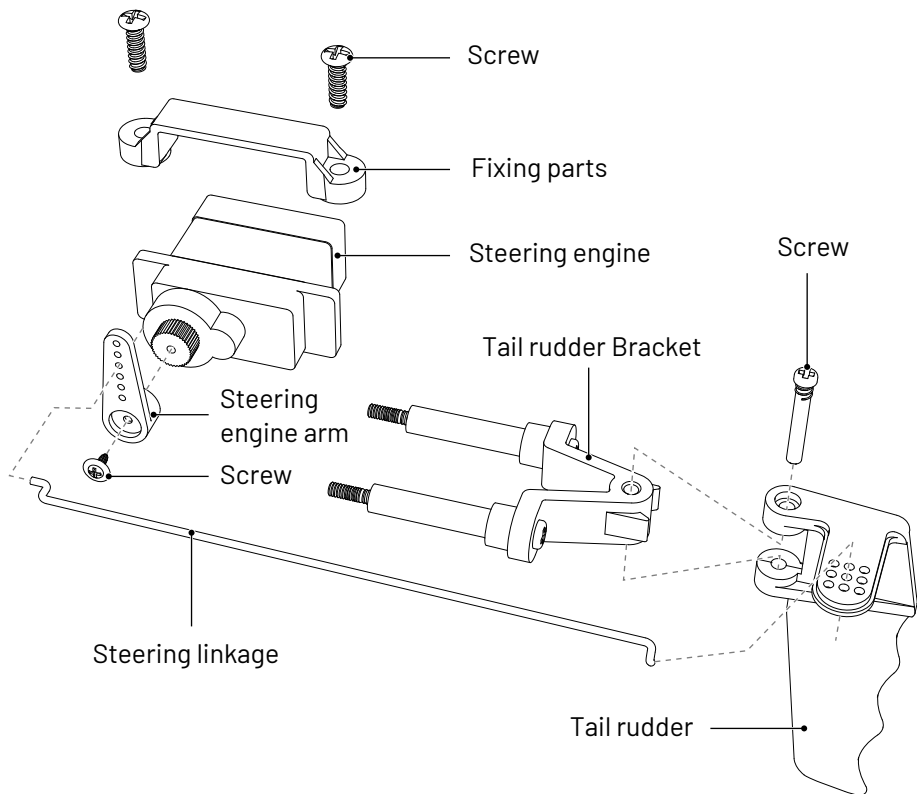

When the new steering gear is powered on, the installation should be conducted in the direction of disassembly sequence. Replace the steering gear with powered on, please noted the propeller turns unexpectedly.

# ASSEMBLY OF BOAT-BATTERY

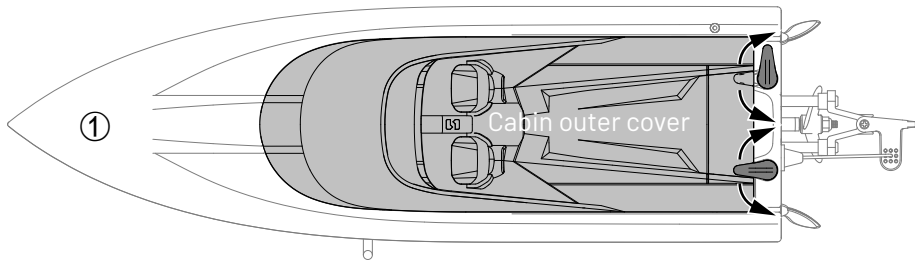

1) Twist the outerlock and take out the cabin outer cover.

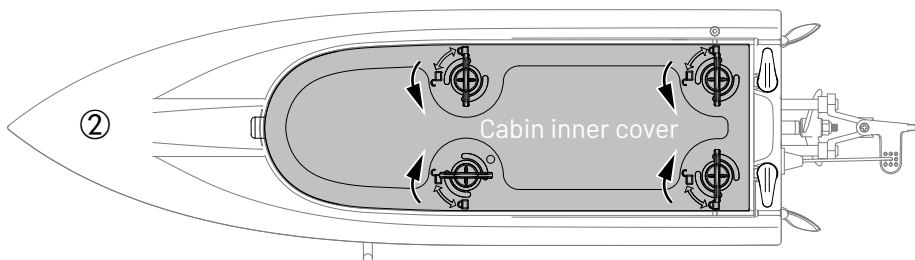

2) Unlock the innerlock and take out the cabin inner cover.

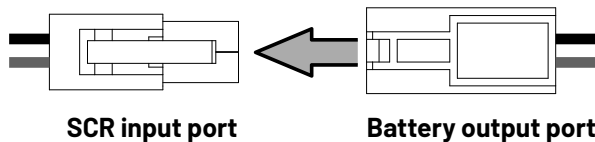
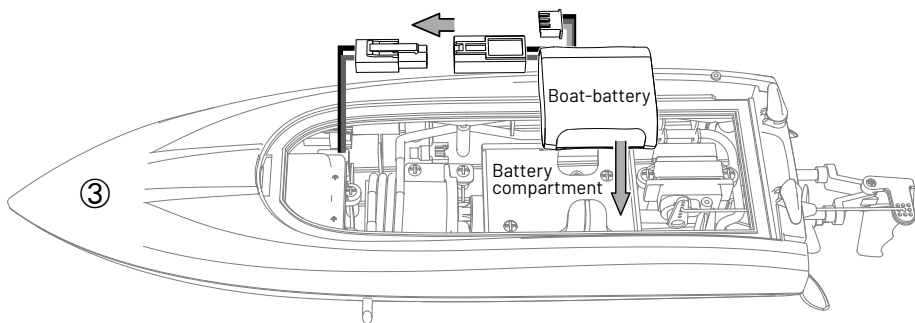

3) Put the boat-battery into the battery compartment and properly connected the SCR input port.

4) Reset the cover and lock it securely.

# FREQUENCY MATCHING



Please make sure the transmitter throttle trigger and Steering wheel to normal before starting up. Do not touch the throttle trigger when turning on the power of the transmitter.

OFF



ON

Transmitter  
Power switch

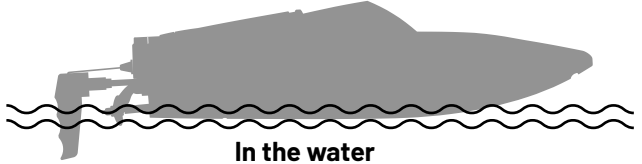

- 1) Power on the transmitter, will sound “di”, and the indicator light flashes to enter the frequency matching.
- 2) After the boat battery is installed and powered on, put the boat into the water, the transmitter will sound “didi”, and the indicator will keep long bright it means frequency matching successful. We can start sailing now!

Tips: It is recommended to be familiar with the operation on the surface of the water before long distance navigation.

## FUNCTIONS

### Low Battery Alarm

**Boat:** When the boat in low battery, the transmitter will beep “di.di.di. ...” constantly to remind the user to remote back the boat as soon as possible. And the boat speed will slow down to half and the capsized reset function will turn off automatically when the boat in low battery.

**Transmitter:** When the transmitter in low battery, the transmitter will beep “di.di.di. ...” to remind the user to remote back the boat to replace the batteries as soon as possible.

### Out of Range Alarm

When the boat is running out of the max remote control distance, the transmitter will beep “didi...didi...” to alarm the user to remote back the boat immediately.

### Out of water protection

Only when the boat is in the water can it work normally. Stop working after leaving the water surface, prevent misoperation and play a role of safety protection.

# Water cooling system

The motor lowers the temperature by flowing water. During the voyage, water flows through the heat pipe around the motor, which has a cooling effect on the motor.

## TROUBLESHOOTING

Problem	Solution
<b>The transmitter indicator light is off</b>	1) Replace the transmitter battery.
	2) Please make sure the battery is installed correctly.
	3) Clean the dirt from metal contacts in battery groove.
	4) Please make sure turn on the power.
<b>Unable to frequency</b>	1) Operate the boat step by step in accordance with the user manual.
	2) Make sure signal interference nearby and keep away.
	3) The electronic component is damaged for frequent crash.
	4) After correctly installing the battery, place it in water.
<b>The boat is under-powered or can not go forward</b>	1) Make sure whether the propeller is damaged or replace a new one.
	2) When the battery is low, charger it in time. Or replace it with a new battery.
	3) If the contact is poor, please remove the power plug and reinsert it.
	4) Make sure install the propeller correctly.
	5) Make sure whether the motor is damaged or replace a new one.
<b>The boat tilts to one side</b>	1) Please make sure the steering is vertical and correct it.
	2) Please make sure the tail rudder is vertical and correct it.
	3) The steering gear is damaged, replace a new one.



**Manufacturer: SHANTOU CITY UDIRC TECHNOLOGY CO., LTD**

Address: Guangfeng Industrial Zone, Guangyi Street, Chenghai District, Shantou City, Guangdong Province, CN